



Coombfield Drive, Dartford, DA2 7LH
Guide price £375,000 Freehold

 3  2  2  D

The Homes Group are delighted to offer to the market this extended three bedroom semi-detached family house that boasts views of the countryside to the rear and is offered with no forward chain.

The property has been extended to the front and rear providing two large living areas, a second shower room and extended bedroom.

The accommodation comprises of an enclosed porch, entrance hall, shower room, a 22'1 x 10' living room, an 18'8 x 9'1 family room and 9'1 x 8'9 kitchen. On the first floor there are three good size bedrooms measuring 12' x 10'5, 10' x 9'8 and 9'2 x 9' respectively plus a family bathroom.

The 40' South West facing rear garden, which benefits from sun for the majority of the day, has a door leading into the 26' x 8'10 garage to the side of the property. There is a block paved driveway to the front and side enabling parking for two/three cars.

Enclosed Porch

10'4 x 3'2 (3.15m x 0.97m)

Entrance Hall

Living room

22'1 x 10' (6.73m x 3.05m)

Family Room

18'8 x 9'1 (5.69m x 2.77m)

Kitchen

9'1 x 8'9 (2.77m x 2.67m)

Shower Room

6' x 5'5 (1.83m x 1.65m)

Landing

8'10 x 6'2 (2.69m x 1.88m)

Bedroom One

12' x 10'5 (3.66m x 3.18m)

Bedroom Two

10' x 9'8 (3.05m x 2.95m)

Bedroom Three

9'2 x 9' (2.79m x 2.74m)

Bathroom

8'10 x 6'1 (2.69m x 1.85m)

Rear Garden

40' (12.19m)

Garage to Side

26' x 8'10 (7.92m x 2.69m)

Driveway

Tenure - Freehold

Council Tax - Band C





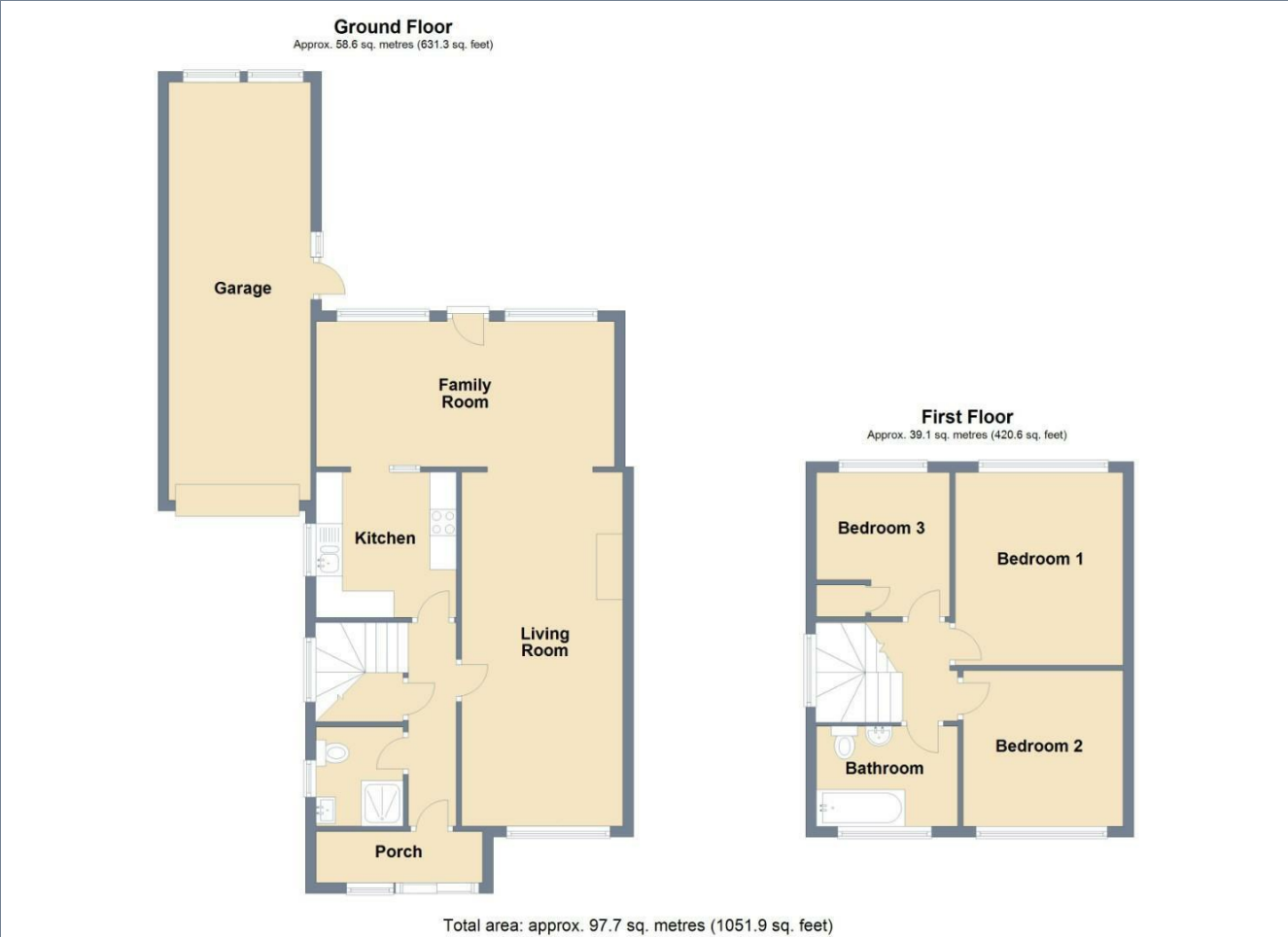

Energy Efficiency Rating		
	Current	Potential
Very energy efficient - lower running costs		
(92 plus) A		
(81-91) B		84
(69-80) C	67	
(55-68) D		
(39-54) E		
(21-38) F		
(1-20) G		
Not energy efficient - higher running costs		
England & Wales	EU Directive 2002/91/EC	

Viewing

Please contact The Homes Group Office on 01322 875000 if you wish to arrange a viewing appointment for this property or require further information.

These particulars, whilst believed to be accurate are set out as a general outline only for guidance and do not constitute any part of an offer or contract. Intending purchasers should not rely on them as statements of representation of fact, but must satisfy themselves by inspection or otherwise as to their accuracy. No person in this firms employment has the authority to make or give any representation or warranty in respect of the property.